

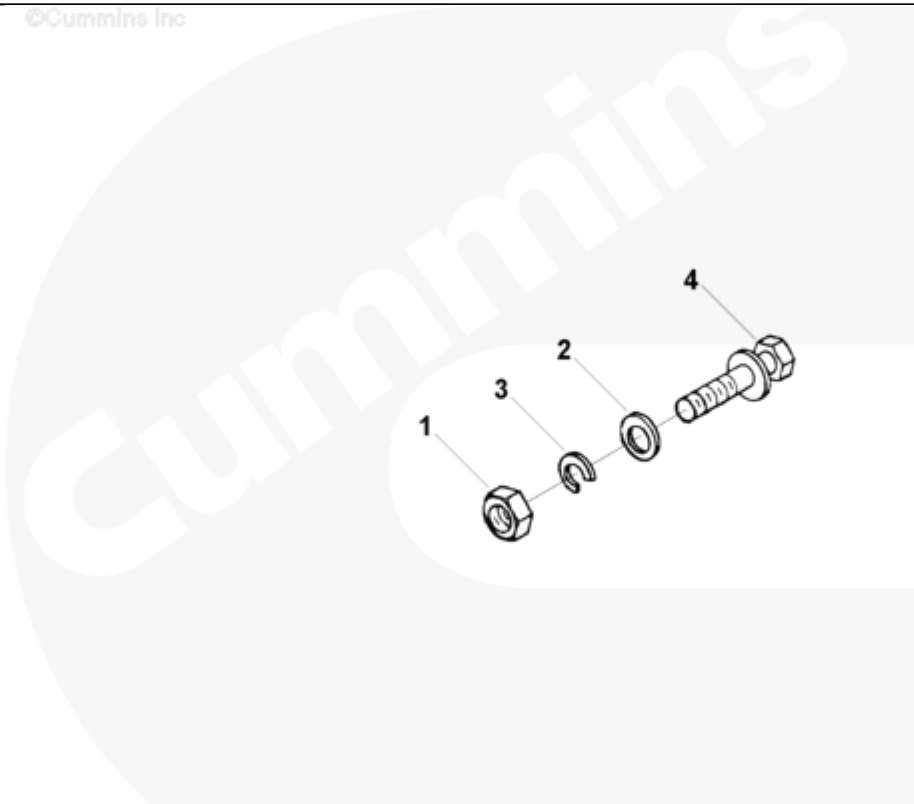

# Parts Catalog - Option Detail

Electronic Parts Catalog - Option Detail				
Option	Group	Graphic	Film Card	Date
FP10151	05.03	fp104gu	FF	28-NOV-95
<b>Engines</b>	G855, G855 CM558, GTA855 CM558 (CM2358) G101, N14 CELECT, N14 CELECT PLUS, N14 MECHANICAL, NH/NT 855, QSM11 CM876 M101, QSM11 CM876 M102M, QSN14 CM876 N103, QSN14 CM876 N105, QSNT14 CM876 N102			

©Cummins Inc



fp104gu

SMALL | MEDIUM | LARGE

Cart	Ref No	Part Number	Part Description	Required	Remarks
<input type="button" value="View My Cart"/>					
		<a href="#">FP10151</a>	Fuel Pump Mounting		<a href="#">Mounting hardware for fuel...(More)</a>
					pump on engine without an air
					compressor.
<input type="checkbox"/>	1	<a href="#">S 274</a>	Heavy Hexagon Jam Nut	4	7/16 - 14 UNC
<input type="checkbox"/>	2	<a href="#">69324</a>	Plain Washer	4	3/8 in.
<input type="checkbox"/>	3	<a href="#">135783</a>	Lock Washer	4	7/16 in.

	4	<a href="#">3818599</a>	Captive Washer Cap Screw	4	7/16 - 14 X 1 7/8 Inch.
--	---	-------------------------	--------------------------	---	-------------------------

© 2019 Cummins Inc., Box 3005, Columbus, IN 47202-3005 U.S.A.  
Terms of Use and Disclaimers | Recommended System Requirements  
Need Assistance? Please click on the Contact Us button in the top right corner of any page.